



Model Number

OCT500-M1A-B3

Diffuse mode sensor
with terminal compartment

Features

- Light/dark ON parameterisable
- AS-Interface certificate
- Pre-fault indication (dynamic, static)
- Protected against mutual interference
- Removable terminal compartment
- Adjustable sensor head
- For glass fibre light guide

Dimensions

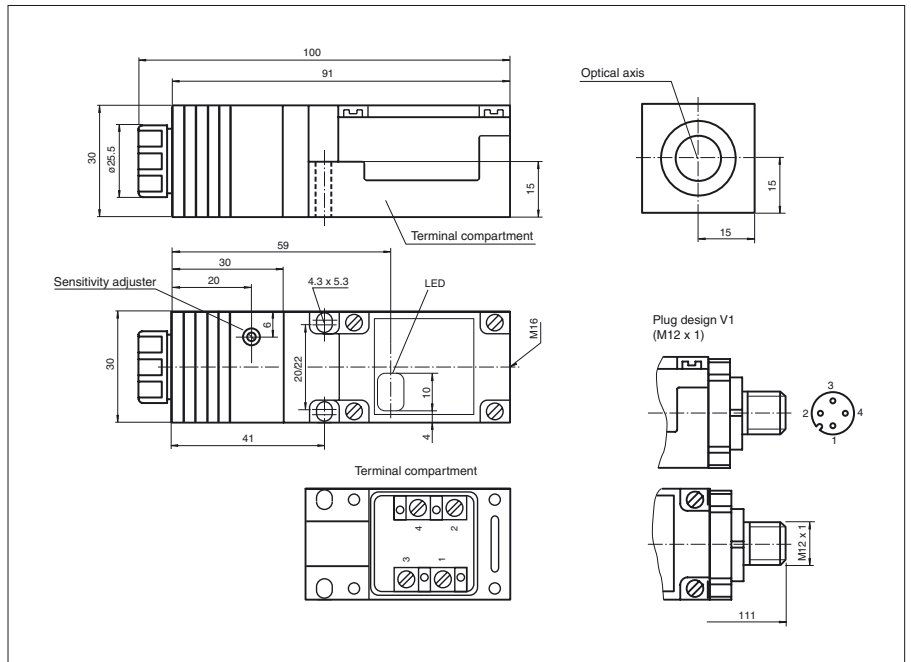

Electrical connection

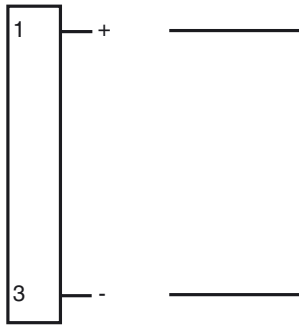

- = Light on
- = Dark on

Release date: 2006-02-21 13:29 Date of issue: 2011-01-26 033178_ENG.xml

Technical data

General specifications

Detection range	without fiberoptic cable : 0 ... 500 mm , with fiberoptic cable see selection table for fiberoptic cables
Detection range min.	0 ... 40 mm
Detection range max.	0 ... 500 mm
Reference target	standard white 200 mm x 200 mm
Light source	LED
Light type	modulated infrared light
Approvals	CE
Ambient light limit	40000 Lux

Indicators/operating means

Operating display	LED green
Function display	LED yellow: switching state LED red: stability control (flashing)
Controls	Detection range adjuster

Electrical specifications

Operating voltage	U_B	via AS-Interface network
Ripple		10 %
No-load supply current	I_0	≤ 40 mA
Time delay before availability	t_v	≤ 20 ms

Output

Output of the pre-fault indication	data bit D1 (not at 1.5 kHz)	
Switching type	light/dark on	
Signal output	AS-Interface	
Switching frequency	f	≤ 1.5 kHz / 200 Hz switchable
Response time		≤ 0.3 ms at 1.5 kHz ≤ 2.5 ms at 200 Hz
Timer function		pulse extension 20 ms, configurable

Standard conformity

Standards	EN 60947-5-2
-----------	--------------

Ambient conditions

Ambient temperature	-25 ... 70 °C (-13 ... 158 °F)
Storage temperature	-40 ... 80 °C (-40 ... 176 °F)

Mechanical specifications

Protection degree	IP67
Connection	M16 terminal compartment, core cross-section ≤ 2.5 mm ²
Material	
Housing	PBT
Optical face	Scratch resistant mineral glass lens
Mass	100 g

Approvals and certificates

CCC approval	Products with a maximum operating voltage of ≤ 36 V do not bear a CCC marking because they do not require approval.
--------------	--

Curves/Diagrams

Characteristic response curve

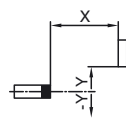
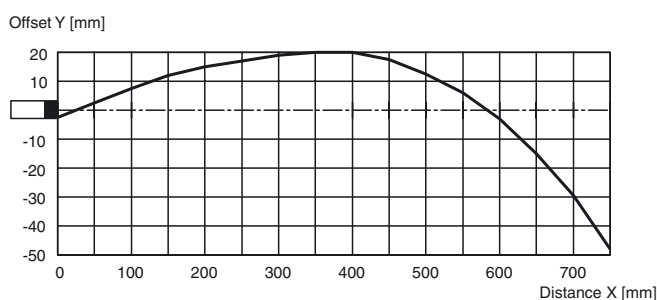

Permissible distance (offset) between optical axis and object.

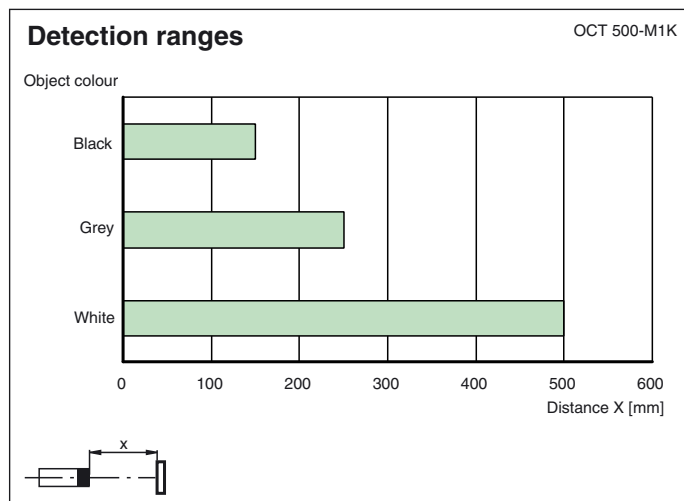

AS-Interface programming

Address preset to 00, can be changed via Busmaster or programming devices

IO code 1

ID code 1

• Data bit

Bit Function

D0 switch output

D1 pre-fault indication (0=ON, 1=OFF)

D2 ready to operate

D3 switching frequency 200 Hz*/1.5 kHz³⁾

• Parameter bit

Bit Function (1/2)

P0 pulse frequency 1*/2

P1 switch output, light*/dark ON

P2 pulse extension (20 ms) OFF*/ON

P3 pre-fault indication³⁾ dynamic*/static

* Default setting

³⁾No activation of pre-fault signal at 1.5 kHz.

Selection table for fibre

	Model number	Range in mm	Detection range in mm	Fig.
fibre optic, single path with PVC coating	LCE 18-2,3-0,5-K2	600		1
	LCE 18-2,3-0,5-K9	600		4
fibre optic, single path with metal coating	LME 18-1,9-0,5-K9	500		4
	LME 18-2,3-0,5-K10	600		5
	LME 18-2,3-0,5-K2	600		1
	LME 18-2,3-0,5-K3	600		2
	LME 18-2,3-0,5-K4	600		3
	LME 18-2,3-1,0-K2	600		1
	LME 18-2,3-2,0-K2	600		1
Glass fibre optics, single path with silicon coating	LSE 18-1,1-0,5-K9	100		4

Release date: 2006-02-21 13:29 Date of issue: 2011-01-26 033178_ENG.xm

Subject to modifications without notice

Pepperl+Fuchs Group
www.pepperl-fuchs.com

USA: +1 330 486 0001
fa-info@us.pepperl-fuchs.com

Germany: +49 621 776-4411
fa-info@pepperl-fuchs.com

Copyright Pepperl+Fuchs

Singapore: +65 6779 9091
fa-info@sg.pepperl-fuchs.com

fibre optic, reflex with PVC coating	LCR 18-2,7-1,0-K9		75	12
	LCR 18-3,2-0,5-K1		100	6
	LCR 18-3,2-0,5-K2		100	7
	LCR 18-3,2-2,0-K2		100	7
	LMR 18-1,1-0,5-K3		10	8
	LMR 18-2,3-0,25-K3		45	8
Glass fibre optics, reflex with metal coating	LMR 18-2,3-0,5-K2		45	7
	LMR 18-2,3-0,5-K3		45	8
	LMR 18-2,3-0,5-K7		45	11
	LMR 18-2,7-0,5-K9		75	12
	LMR 18-3,2-0,5-K1		100	6
	LMR 18-3,2-0,5-K5		100	10
	LMR 18-3,2-1,0-K1		100	6
	LMR 18-3,2-1,0-K5		100	10
	LMR 18-3,2-2,0-K1		100	6
	LMR 18-3,2-2,0-K4		100	9
	LMR 18-3,2-3,0-K1		100	6
fibre optic, reflex with silicon coating	LSR 18-2,3-0,5-K12		45	13
	LSR 18-3,2-0,5-K1		100	6

Other lengths and end pieces available on request

Fig. 1

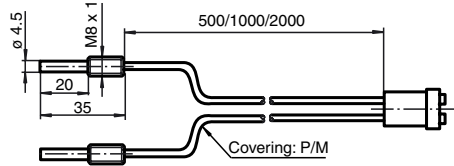

Fig. 2

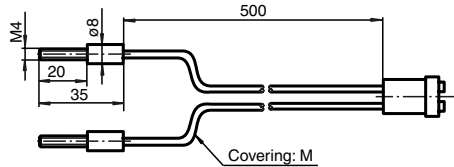

Fig. 3

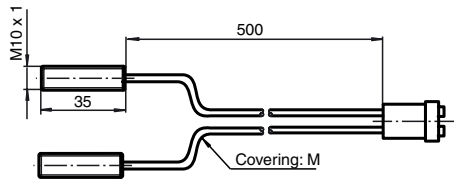

Fig. 4

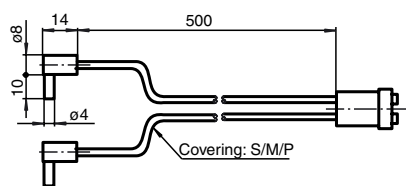

Fig. 5

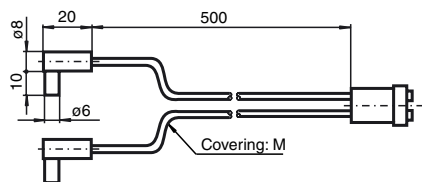

Fig. 6

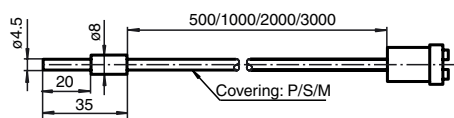

Fig. 7

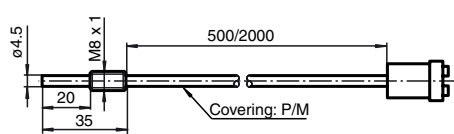

Fig. 8

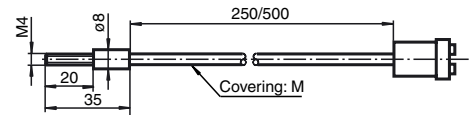

Fig. 9

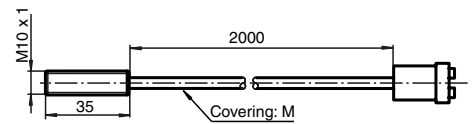

Fig. 10

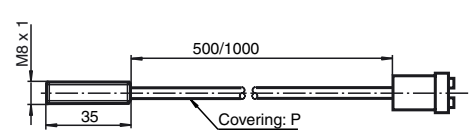

Fig. 11

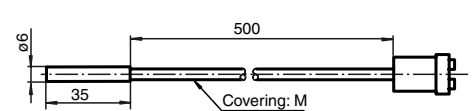

Fig. 12

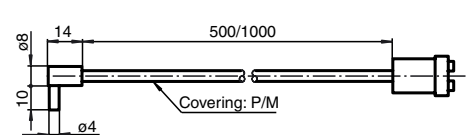
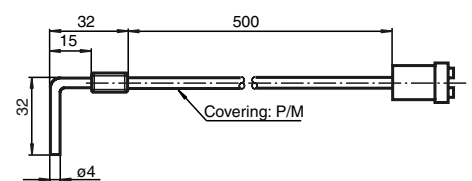
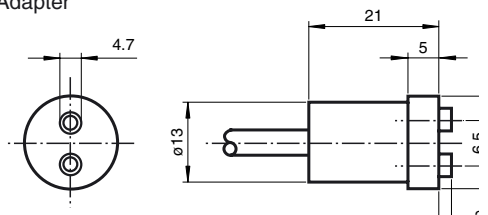

Fig. 13



Adapter



Release date: 2006-02-21 13:29 Date of issue: 2011-01-26 033178_ENG.xml