

Series -F8

Dimensions



Diffuse reflective photoelectric sensor

OCT800-F8-E4
OCT800-F8-E5

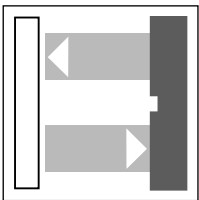

800 mm



Features

- Light/Dark ON, switchable
- Terminal compartment
- Pre-fault indication and output (static)
- Protection degree IP66
- Supplied with mounting accessory

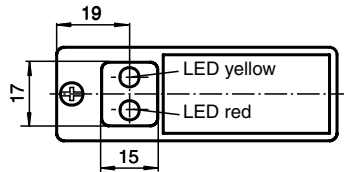
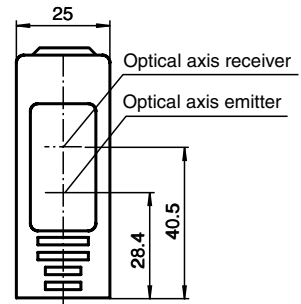
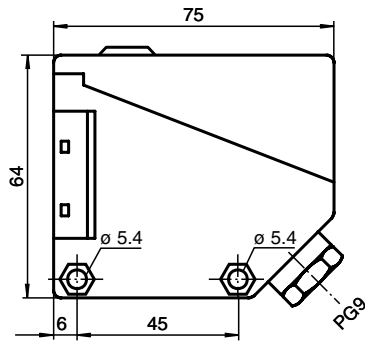

Mounting accessories etc., see section "accessories"

Electrical connection

E4:

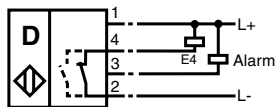

E5:

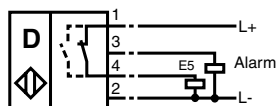

Technical data

Valid for the whole family

General specifications

| | |
|---------------------|---|
| Sensing range | 0 ... 800 mm |
| Adjustment range | 65 ... 800 mm |
| Reference target | Standard white 200 mm x 200 mm |
| Operating mode | Light/Dark ON, switchable |
| Light type | IR-light 940 nm |
| Ambient light limit | ≤ 10000 Lux sun light ≤ 7500 Lux halogen light |
| Standard conformity | EN 60947-5-2 |

Electrical specifications

| | |
|--------------------------------|---|
| Rated operational voltage | U_e 10 ... 30 V DC, ripple 10 % _{SS} |
| No-load supply current | I_0 ≤ 35 mA |
| Time delay before availability | t_v 50 ms |

Indicating/operating means

| | |
|---------------|---------------------------------|
| LED yellow | Switching state |
| LED red | Pre-fault indication |
| Potentiometer | Adjustment of the sensing range |

Output

| | |
|---------------------------|--|
| Rated operational current | I_e 200 mA, short circuit/overload protected |
| Voltage drop | U_d ≤ 3 V |
| Switching frequency | f ≤ 300 Hz |
| Switch-on delay | t_{on} 15 ms |
| Range hysteresis | H ≤ 15 % |

Ambient conditions

| | |
|---------------------|-------------------------------|
| Ambient temperature | -25 ... 55 °C (248 ... 328 K) |
| Storage temperature | -40 ... 55 °C (233 ... 328 K) |

Mechanical specifications

| | |
|-------------------|---|
| Protection degree | IP66 according to EN 60529 |
| Connection type | Terminal compartment PG9, ≤ 2.5 mm ² |
| Material | |
| Housing | PBT |
| Light exit | PMMA |
| Mass | 100 g |

Version data

| Model number | OCT800-F8-E4 | OCT800-F8-E5 |
|--------------|---|---|
| Output type | 1 switch output E4, npn NO/ NC Pre-fault output, NO, static | 1 switch output E5, pnp NO/ NC Pre-fault output: NO, static |

Model number

OCT800-F8-E4
OCT800-F8-E5

Characteristic curves

Characteristic response curve

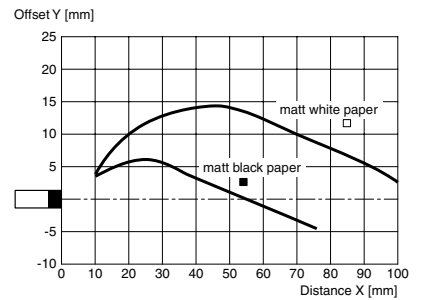

Permissible distance (offset) between optical axis and object.

